

Cl/SfB	(31)	Zt4
CAW P10		
Uniclass L675:P91		

## Description

TP652 Compriband Trio Plus is an open cell, pre-compressed, impregnated, soft polyurethane foam impregnated with flame-retardant resin. The various vapour diffusion properties are achieved by an inner step band and unique (patented) side impregnation.

This multi-functional sealing tape has been developed to meet the increased demands of Passiv Houses, new construction and refurbishment projects.

## Colour

Anthracite

Interior: anthracite/grey with charcoal-grey powder

## Packaging

Supplied on pre-compressed rolls, with self-adhesive on one side for initial location.

## Available Sizes

Passiv House~ - Joint Gap (mm)	Joint Depth* (mm)	m/roll
6 - 10 (S)	58	8
6 - 10 (S)	66	8
6 - 10 (S)	77	8
6 - 10 (S)	88	8
8 - 15 (M)	58	6
8 - 15 (M)	66	6
8 - 15 (M)	77	6
8 - 15 (M)	88	6
10 - 20 (L)	58	5
10 - 20 (L)	66	5
10 - 20 (L)	77	5
10 - 20 (L)	88	5
15 - 30 (XL)	58	3
15 - 30 (XL)	66	3
15 - 30 (XL)	77	3
15 - 30 (XL)	88	3

Dimension tolerance in accordance with DIN 7715 P3.

\* Illbruck TP652 Compriband Trio Plus should completely fill the window depth less 2 mm set back to each face.

~ UV-resistant

## Technical Information

Property	Test Method	Result
Building Materials Class	4102	B2 (normally flammable)
Thermal Conductivity	52 612	$\lambda_{10} = 0.048 \text{ W/m.K}$
U-value - Window depth: 60 mm		0.8 W/(m².K)
U-value - Window depth: 70 mm		0.7 W/(m².K)
U-value - Window depth: 80 mm		0.6 W/(m².K)
Water Vapour Diffusion, Sd Value	EN ISO 12572	< 0.5 m
Drop In Vapour Pressure		interior more tightly sealed through a step band and side impregnation
Joint Permeability	EN 1026	$a < 0.1 \text{ m}^3/[\text{h.m.}(\text{daPa})^{2/3}]$
Resistant to Driving Rain	EN 1027	600 Pa
Sound Insulation	EN ISO 717-1	51 dB in 15 mm joint, plastered on one side
Compatibility with Traditional Building Materials	18 542	In accordance with BG1, perform a compatibility test on products that contain solvents or plasticisers
Emission Test	AgBB/ DIBt method	Suitable for interior use



## TP652

### Compriband Trio Plus

#### Usage / Purpose

TP652 is used to seal window and door connecting joints against wind and driving rain while providing thermal insulation for the entire installation depth and an airtight internal barrier. The product can also be used for sealing panel joints in for example off-site construction. TP652 Compriband Trio Plus ensures breathable sealing in accordance with the "inside tighter than outside" principle.

#### Key Benefits

- Large number of multi-functional uses (from Passiv Houses to refurbishment projects)
- Approximately 80% time savings during assembly because one product is used for inner, intermediate and outer sealing
- Resistant to driving rain, thermally insulated and airtight
- Emission-free, suitable for indoor use (emission test in accordance with the AgBB/DIBt method)
- Modern management of dampness and vapour control

### How to Select Appropriate Size

- First select joint width (tape thickness) then joint depth (tape width), e.g. for an 8 mm wide joint and a tape width of 77 mm, the specification will be: 'TP652 Compriband Trio Plus S77'. Please note, the installed face of the tape should be set back 2 mm from the face of the joint. For example, for the tape width above, this would be suitable for a frame size of 81 mm (2 mm set back each side).

### Installation Method

- TP652 Compriband Trio Plus replaces three sealing products with one (Figure 1). Before the window is installed, TP652 Compriband Trio Plus is fixed to the frame. The transition to all sides must be airtight and sealed against driving rain throughout. We recommend sealing the corners and where the tape locates around fixing brackets with illbruck SP525 adhesive. Below the exterior window sill, it may be necessary to use a secondary water resistant layer (eg ME501 Duo HD Membrane or ME220 EPDM Membrane) so that water will be conducted outwards in a controlled fashion. For cavity wall construction, distance mounting can be used to secure the window. Alternatively, for solid reveals, through-frame fixing is used.

### Application

- After determining the component depth and joint width, select the tape dimension according to the table. Please note, other tape widths are available.
- Clean the wall opening to clear away construction contamination and mortar remnants. In the sealing area, mortar should be applied to achieve flush brick joints.
- Clean the sides of the window frame.
- Cut off the tapered start or end pieces on the roll and fix the tape using the self- adhesive. Allow an extra 20mm/m when trimming the tape (cut to suit the joint dimension rather than the frame).
- Ensure the charcoal-grey powdered side is facing towards the inside.
- At site temperatures above 20°C, the tape should be kept in a cool place. At site temperatures below 8°C, the tape should be kept as close as possible to room temperature. High temperatures accelerate the expansion while low temperatures retard expansion.

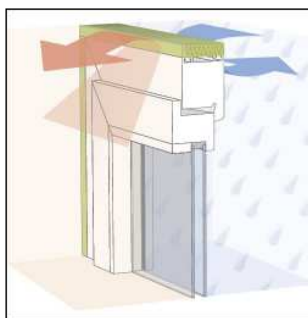

Fig. 1  
3 level sealing - weather & air tightness, & thermal insulation

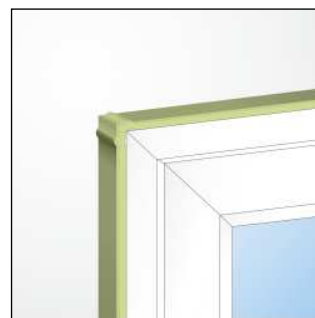

Fig. 2  
Butt joint at corner

### Installation Instructions for Window Corners

- TP652 should be tightly butt-jointed at the corners, allowing 20 mm/m of extra material. Any gaps at the corners or around fixing brackets can be sealed using SP525 adhesive.

### Please Note

Compatibility with different paint and sealant coatings must be tested. TP652 can also be used on window frames with coupling bars. We recommend the use of slot cover profiles in certain applications.

### Health & Safety Precautions

Safety data sheet must be read and understood before use.



#### Technical Service

tremco illbruck has a team of experienced Technical Service Representatives who provide assistance in the selection and specification of products. For more detailed information, service and advice, please call Customer Service on 0191 419 0505.

#### Guarantee / Warranty

tremco illbruck products are manufactured to rigid standards of quality. Any product which

has been applied (a) in accordance with tremco illbruck written instructions and (b) in any application recommended by tremco illbruck, but which is proved to be defective, will be replaced free of charge.

No liability can be accepted for the information provided in this leaflet although it is published in good faith and believed to be correct. tremco illbruck Ltd. reserves the right to alter product specifications without prior notice, in line with Company policy of continuous development and improvement.



**tremco illbruck Limited**  
3A Walton Road, Pattinson North  
NE38 8QA Washington  
T: +44 191 419 0505  
F: +44 191 419 2200

sales.uk@tremco-illbruck.com  
www.tremco-illbruck.co.uk